

Changing tubes

Tubing on both moulded and thin tube hearing aids can become brittle or damaged over time. We therefore recommend that tubes be changed approximately every 6-8 months.

You may attend our drop-in service for a clinician to replace these for you, however if you feel confident to do this yourself at home we can provide you with spare tubes.



Aid with earmoulds

What you need:

- A pair of pliers.
- Pair of sharp scissors or clippers.
- New tubing.

1. Detach your hearing aid from the tubing then, using pliers if needed, pull the old tube out of the mould.

Save the old tube as you will need it later.

2. Take a new piece of tubing and cut the shorter arm diagonally so it tapers to a point.

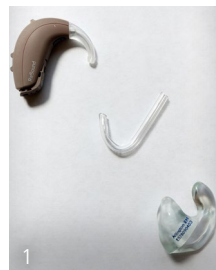

3. Thread the pointed end of the tube into the large hole at the back of the mould. If there are two holes – the upper one is for the tubing and the lower hole is a vent.

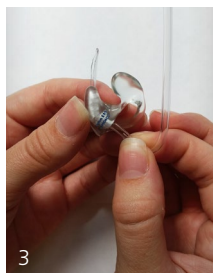
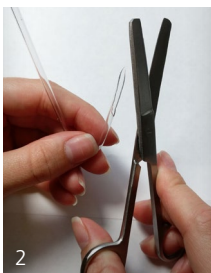

4. Pull the point of plastic that emerges at the tip of the mould using the pliers until the opposite end of the tube is standing approximately upright.

5. Using clippers or sharp scissors trim the tube close to the tip of the mould.

6. Use the old piece of tubing that you saved to measure the correct length for the new tubing and trim to match.

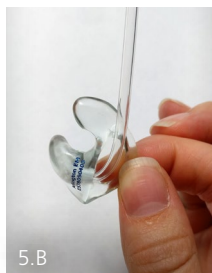
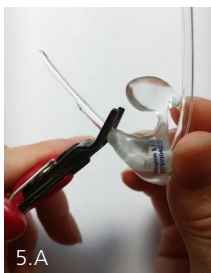

7. Push the tubing onto the hook of the hearing aid holding both firmly until it is securely in place. Make sure that the mould is pointing in the right direction.

8. Try the aid on and make sure it sits comfortably. If the aid is flapping off the ear then detach the mould and trim a small amount, eg 2mm and reattach.



9. If you are getting pain on the top of the ear after wearing the aid for a while then you have made the tubing too short and need to replace it.



If you are happy to change your tubes yourself at home, please ask your audiologist for some spares as this may save you a future trip to the drop-in clinic..

Aids with thin tubes

1. Remove the old thin tube from the hearing aid by pinching it where it joins to the hearing instrument and unscrewing it counter-clockwise. Dispose of the old thin tube.

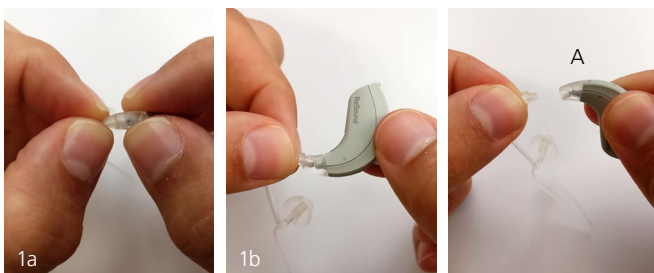

Make sure the small clear 'connector' (marked A) remains attached to the aid.

2. Select the correct new thin tube for the hearing aid; **right** hearing aids and tubes will be marked with a **red** marker, **left** hearing aids and tubes are marked with a **blue** marker.
3. To attach the new thin tube, hold the screw end of the thin tube and push it into the 'connector' portion of the aid – you may feel a click.
4. Hold the tip of the tube and wind the hearing aid clockwise until it is finger tight and the aid is correctly aligned with the tube as shown in the picture.

Do not over tighten as you may kink the tubing.

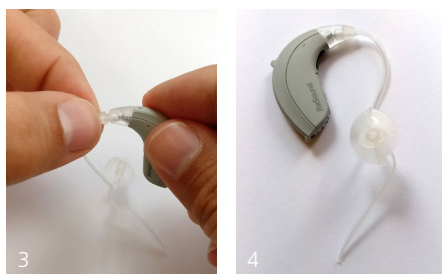

If you are happy to change your tubes yourself at home, please ask your audiologist for some spares as this may save you a future trip to the drop-in clinic.